



Figures & Appendices

Fig 1 Site Location Plan

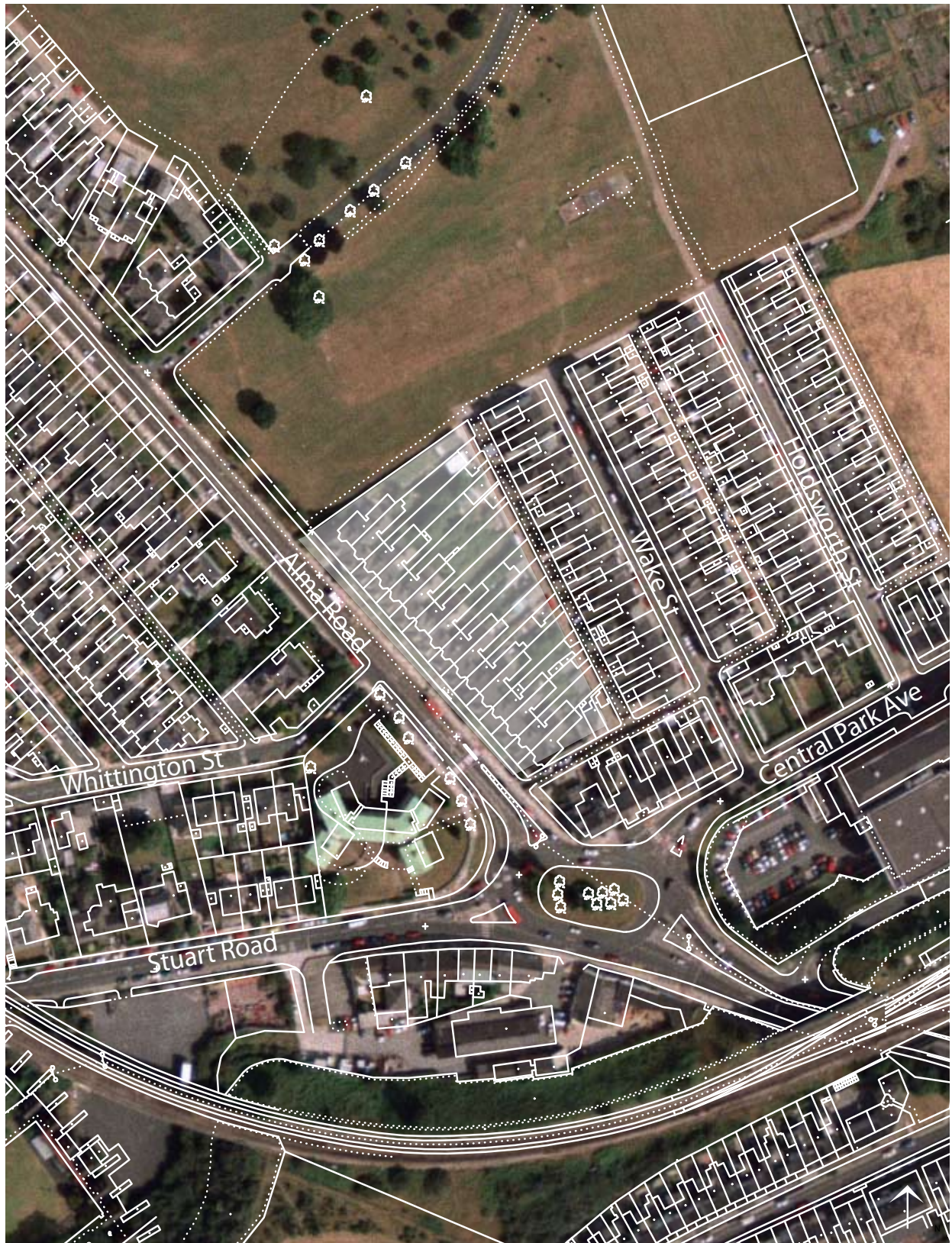

Fig 2 Site Context

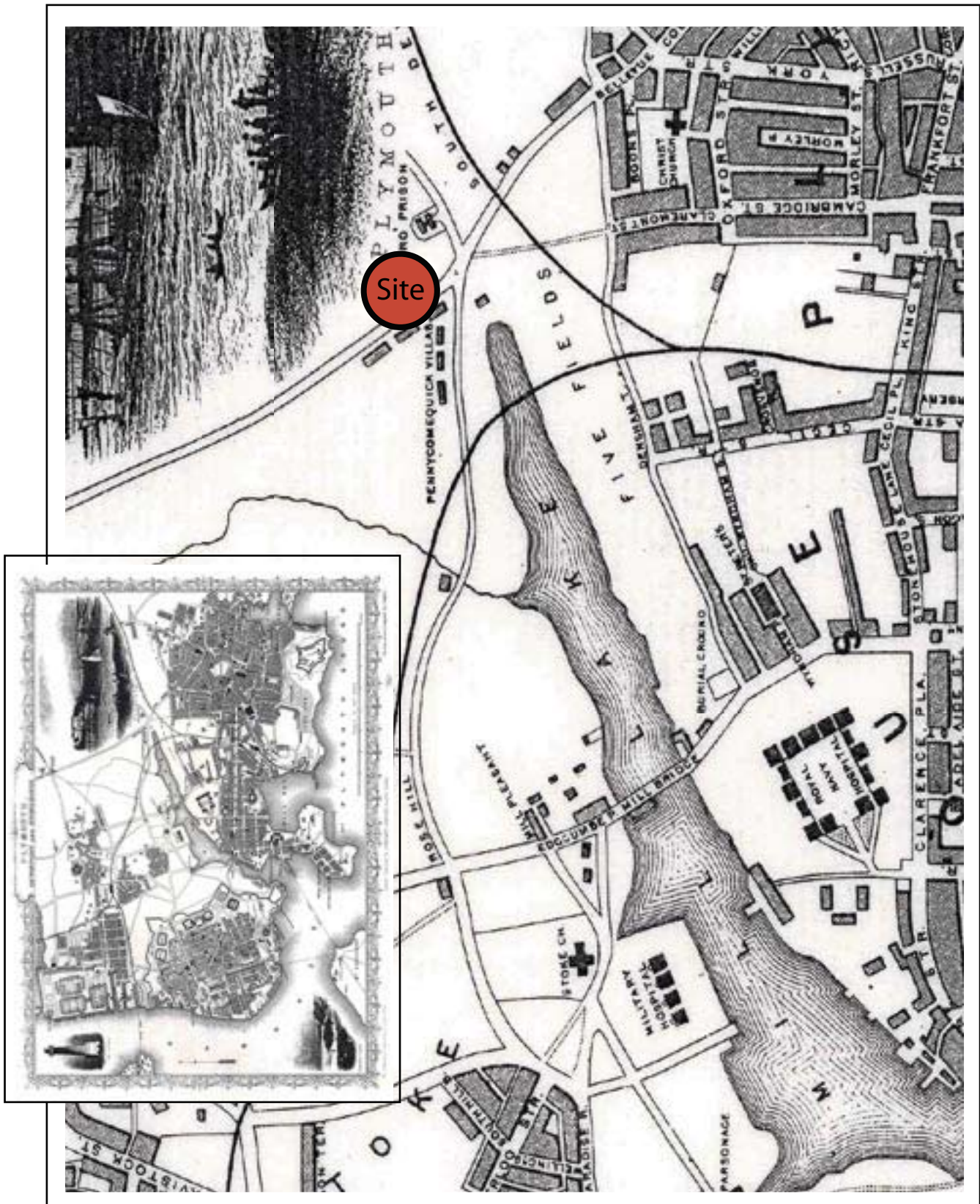
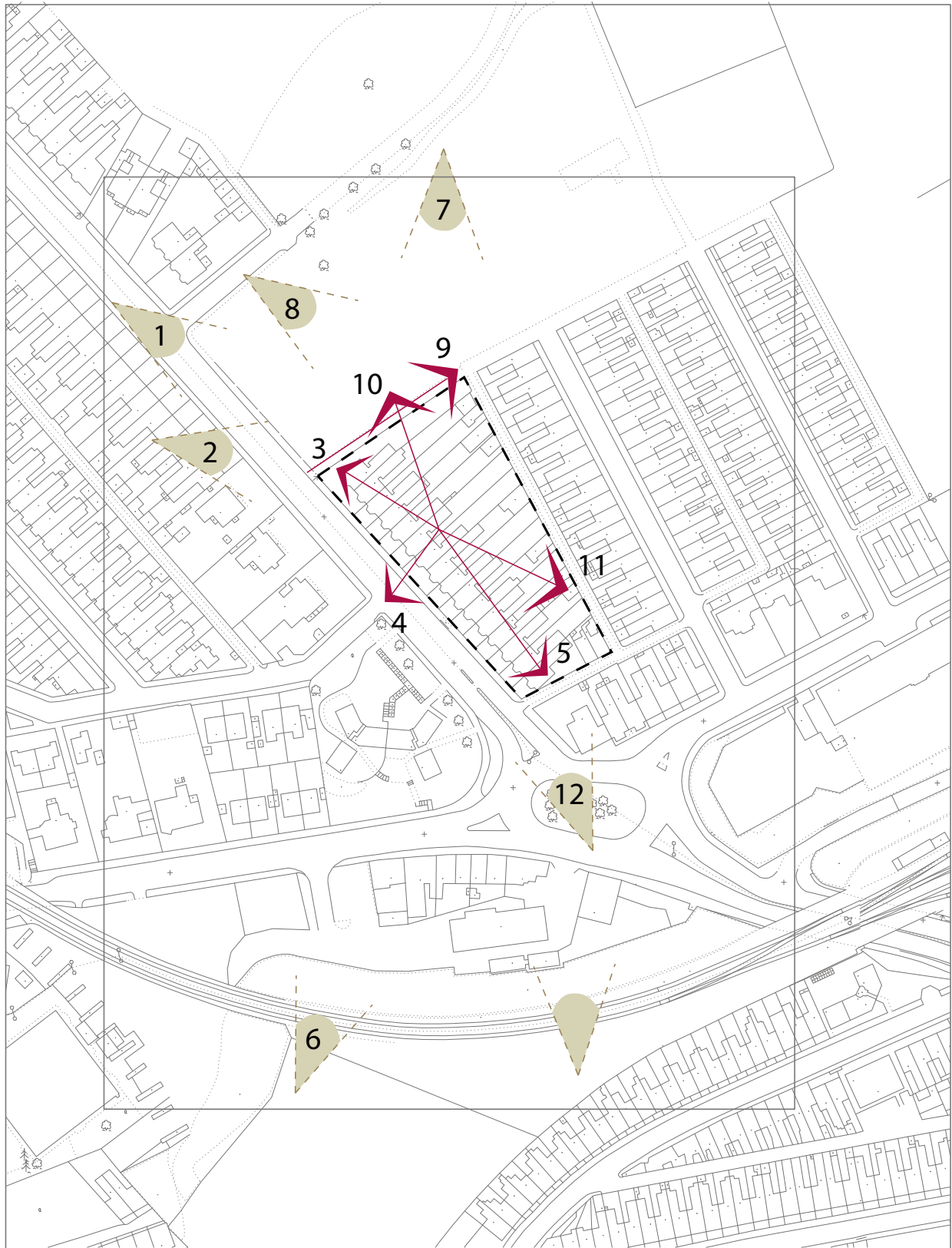

Fig 3 Views and Vistas



(c) Crown Copyright. Plymouth City Council. Licence No LA078972.2003

Views on to the Site Views out of the Site



Views & Vistas



1



2



3



4



5



6



7



8



9



10



11



12

Fig 4 Land Uses Context



(c) Crown Copyright, Plymouth City Council. Licence No LA078972.2003









- | | | |
|---|--|---|
|  Site Indication |  Railway |  Central Park |
|  Private Residential |  Social Housing |  Retail / Amenities Buildings / Accomodation |
|  Public House |  Retail Outlets |  Employment Area |

Fig 5 Transport Context



(c) Crown Copyright. Plymouth City Council. Licence No LA078972.2003

- Site location
- Railway
- Bus Stops
- Main A Road
- Residential Streets
- One way System

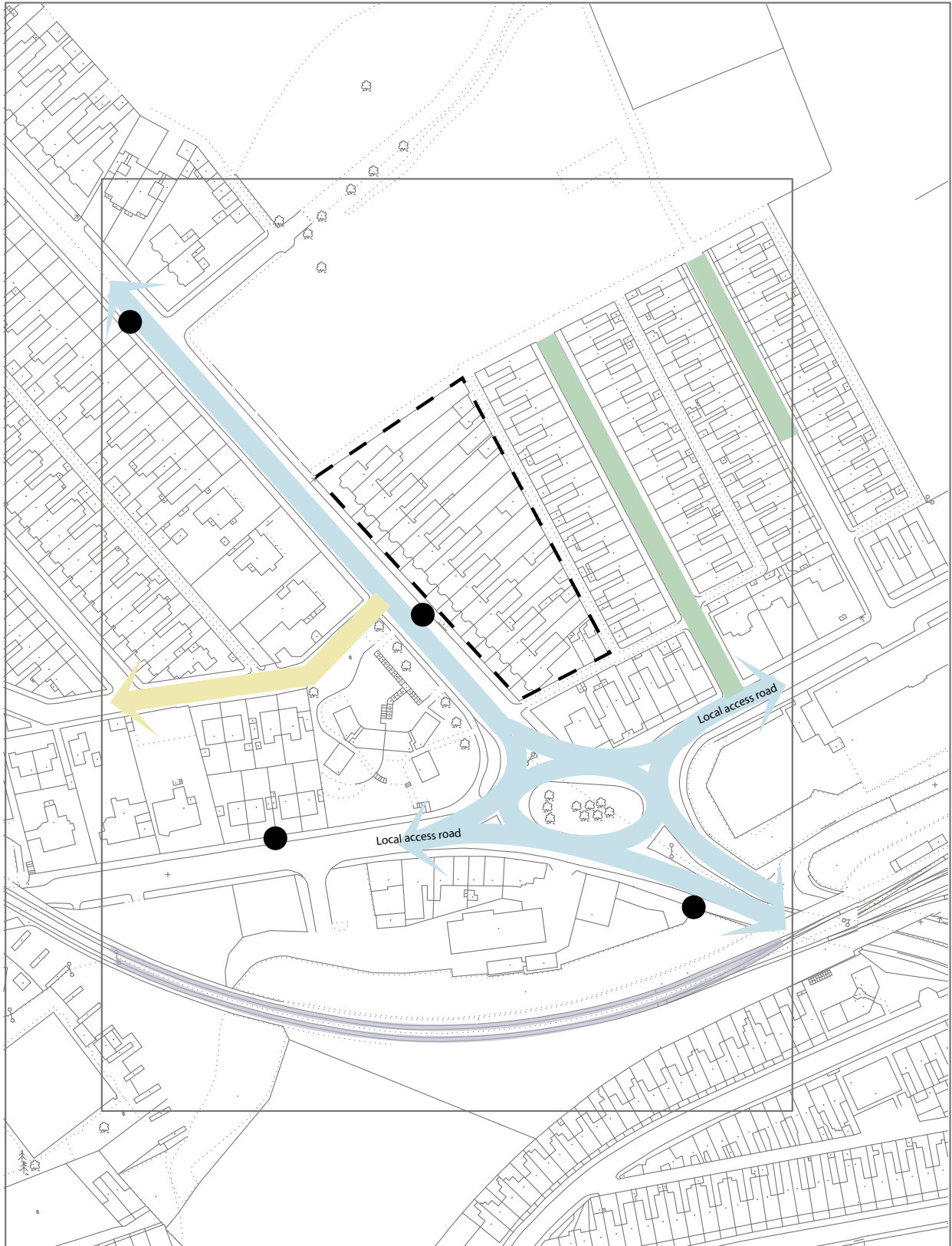
Fig 6 Building Typologies

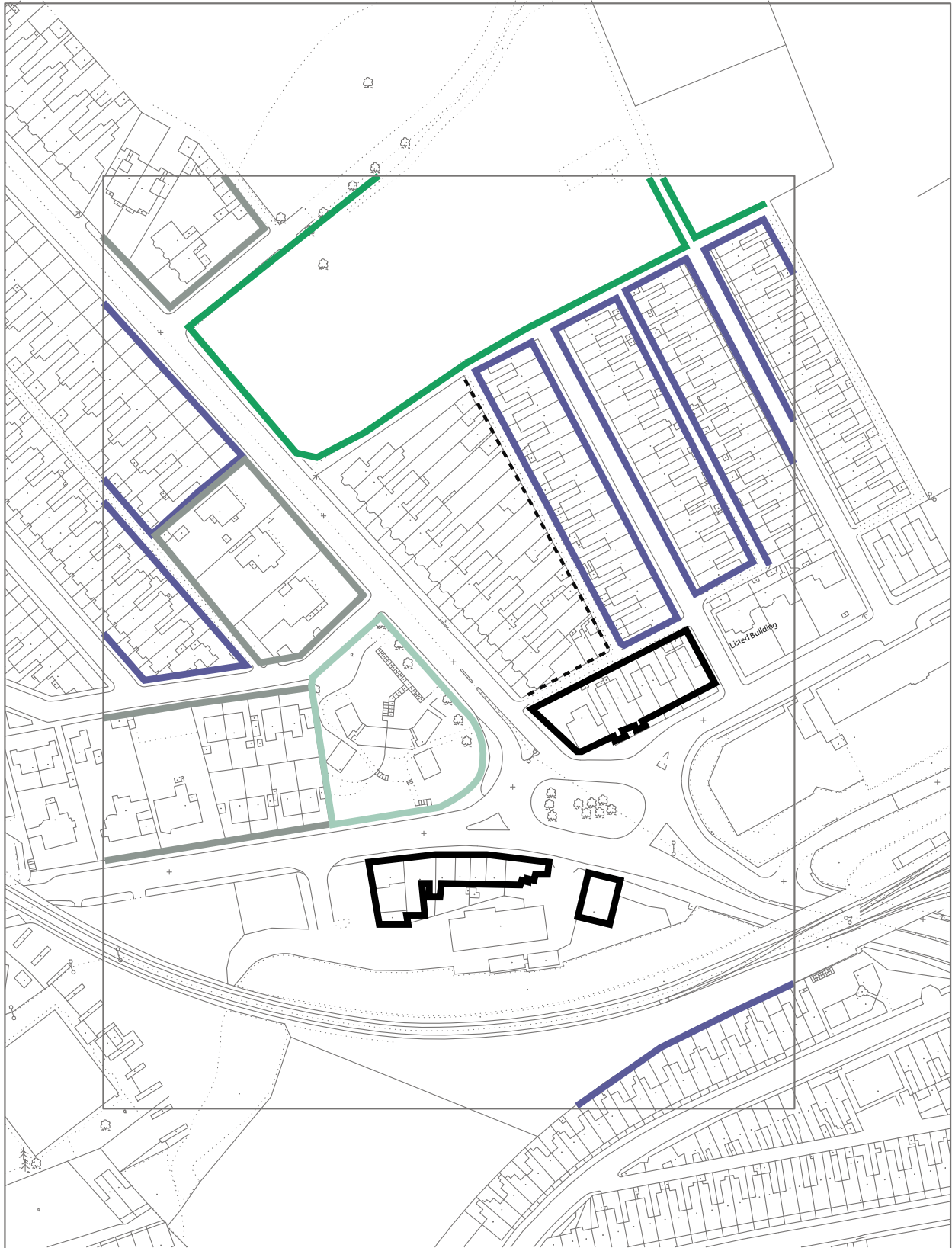

(c) Crown Copyright, Plymouth City Council, Licence No LA078972.2003

- 2 storey Victorian terraces
- 3-4 storey 1960s social housing
- 2-3 storey Victorian terraces
- 2-3 storey detached / semi detached

Fig 7 Building Heights



(c) Crown Copyright. Plymouth City Council. Licence No LA078972.2003

- Two Storey
- Three Storey Retail
- Four Storey

Fig 8 Concept Plan Proposals



(c) Crown Copyright. Plymouth City Council. Licence No LA078972.2003

-  Active/Natural Surveillance
-  Pedestrian Greenlinks
-  Frontage
-  Vehicle Access
-  Important Corner



